

ACTUAL PARTS
 MAY NOT APPEAR
 AS SHOWN

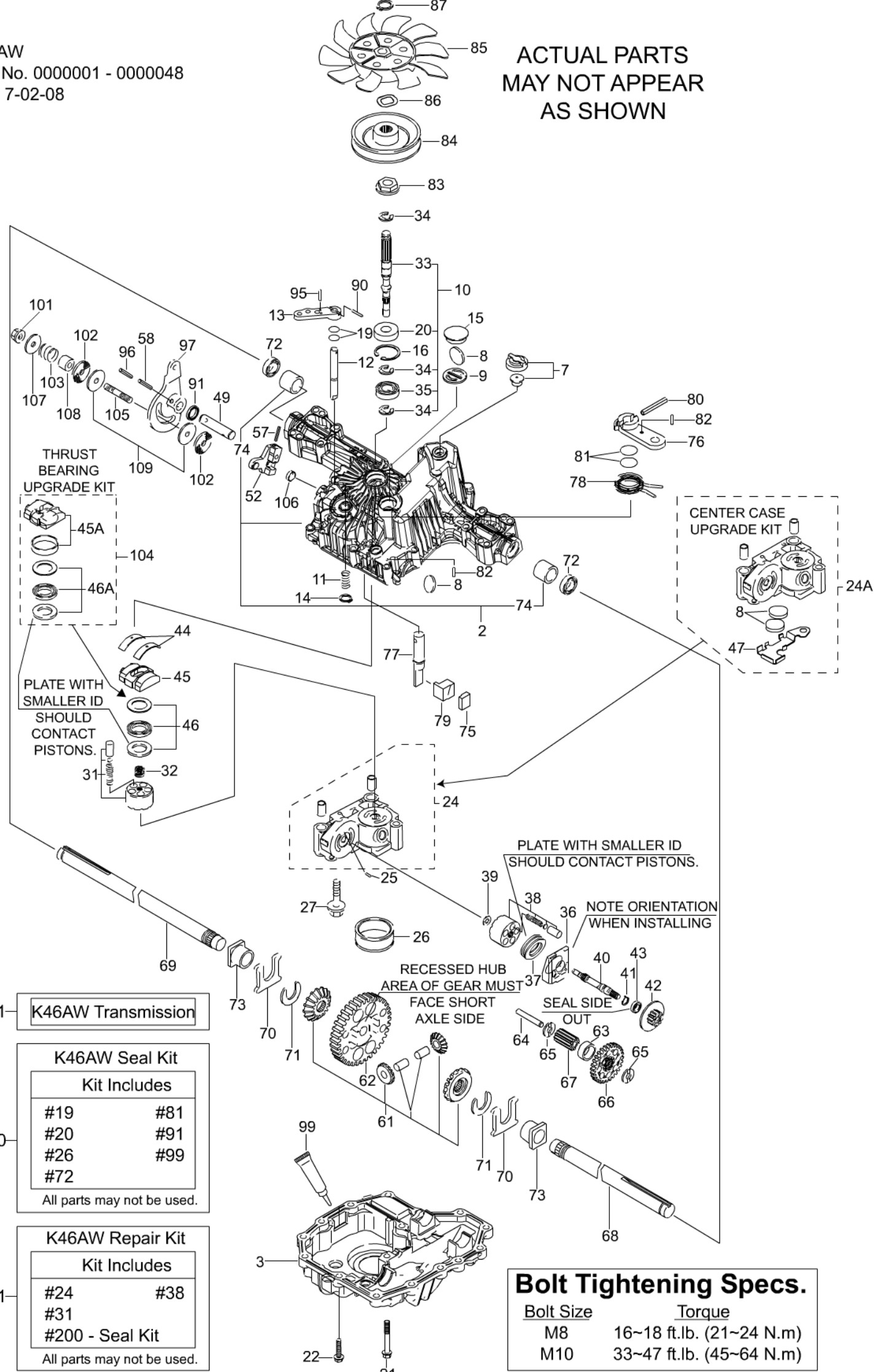

1 K46AW Transmission

200 K46AW Seal Kit
 Kit Includes
 #19 #81
 #20 #91
 #26 #99
 #72
 All parts may not be used.

201 K46AW Repair Kit
 Kit Includes
 #24 #38
 #31
 #200 - Seal Kit
 All parts may not be used.

PLATE WITH SMALLER ID SHOULD CONTACT PISTONS.

NOTE ORIENTATION WHEN INSTALLING

RECESSED HUB AREA OF GEAR MUST FACE SHORT AXLE SIDE

SEAL SIDE OUT

Bolt Tightening Specs.

Bolt Size	Torque
M8	16~18 ft.lb. (21~24 N.m)
M10	33~47 ft.lb. (45~64 N.m)

K46AW

K46AW 000001-000048 (K46AW-7A646084090)

KEY NO.	PART NO.	DESCRIPTION	TUFF TORQ PART NO
1	525 32 40-01	K46AW EPH TRANSAXLE	7A646084090
2	505 56 36-01	UPPER CASE KIT	1A646084421
3	522 54 05-01	LOWER CASE	1A646024163
7	522 96 12-01	VENT VALVE	168T2024250
8	535 40 28-29	MAGNET 28 * 3.5	19216324360
9	502 45 20-01	MAGNET HOLDER	1A646029000
10	502 46 36-01	PUMP SHAFT/BEARING KIT	1A646099950
11	502 46 01-01	SPRING 25	19215427281
12	505 56 40-01	BYPASS SHAFT A	1A646029510
13	535 40 28-17	BYPASS LEVER	1A632029520
14	535 40 28-49	SNAP RING 10	19216829570
15	535 40 28-32	SEALING CAP 30	1C655036300
16	535 40 28-50	SNAP RING C 35	22252000350
21	535 40 28-51	TAPPING SCREW 8 * 55	26476080552
22	535 40 28-28	TAPPING SCREW 8 * 30	26476080302
24	522 53 82-01	CENTER CASE F	1A646024870
25	535 40 28-58	PIN 3 * 9.8	19216824760
26	535 40 28-59	FILTER 105	168T2025220
27	535 40 28-63	BOLT 10 * 75	26106100752
31	535 40 28-64	CYLINDER BLOCK (PUMP) KIT	19216825111
32	535 40 28-69	SPRING	1A646025200
33	505 56 45-01	PUMP SHAFT, STANDARD	1A646025251
34	535 40 28-07	E-RING 15	19215485310
35	535 40 28-71	BEARING 6202C3	24101062020
36	535 40 28-72	MOTOR HOUSING	19216824210
37	522 53 85-01	THRUST BEARING 51106	1A646034750
38	535 40 28-74	CYLINDER BLOCK KIT	19216825210
39	535 40 28-79	WASHER 12 * 24 * 1	19216825230
40	502 45 17-01	MOTOR SHAFT	1A646025271
41	535 40 28-81	SNAP RING S15	19215425310
42	522 54 10-01	BRAKE DISC/MOTOR GEAR (10T)	1A646085250
43	535 40 28-83	BEARING 6202 RSR C3	168T2025280
44	535 40 28-84	THRUST METAL	19216327051
52	522 53 88-01	CONTROL ARM D	1A646029770
56	502 45 24-01	COTTER PIN 1/8" * 3/4"	1A646029940
58	535 40 28-09	ROLL PIN 6 * 40	22351060040
61	535 40 28-99	DIFF GEAR KIT	1A646031570
62	535 41 46-04	FINAL GEAR (54T)	1A646033520
63	535 41 46-05	FINAL PINION COLLAR	1A646033250
64	535 41 46-06	REDUCTION SHAFT	1A646088820

KEY NO.	PART NO.	DESCRIPTION	TUFF TORQ PART NO.
65	502 46 07-01	WASHER 12 * 32 * 3.2	19216833420
66	502 45 30-01	REDUCTION GEAR (38T)	1A646085240
67	502 45 27-01	FINAL PINION GEAR (10T)	1A646033531
68	535 41 46-10	AXLE SHAFT, LEFT	1A646034111
69	535 41 46-11	AXLE SHAFT, RIGHT	1A646034121
70	535 41 46-12	THRUST WASHER	19216334261
71	535 41 46-13	RING 17	19216834270
72	535 40 28-37	SEAL 19 * 32 * 8	19216334280
73	535 41 46-14	BUSHING 19 * 25	19216834350
74	502 85 33-01	BUSHING 19.05	168T2034240
75	535 41 46-16	BRAKE SHOE	1A646036121
76	535 40 28-38	BRAKE LEVER	1A646036160
77	535 41 46-17	BRAKE SHAFT	1A646036171
78	535 40 28-39	BRAKE RETURN SPRING	168T2036180
79	535 41 46-18	BRAKE ACTUATOR	1A646036200
80	535 40 28-40	SPRING PIN 5 * 32	22351050032
82	535 40 28-41	SPRING PIN 4 * 16	22351040016
83	506 98 66-01	SPLINE COLLAR	1A646025300
84	502 45 19-01	PULLEY L	1A646025810
85	506 98 68-01	FAN, BLACK	1A646083070
86	506 98 65-01	WAVE WASHER	1A646083060
87	735 31 15-00	SNAP RING	19215489090
90	535 40 28-16	SPRING PIN 3.0A * 20	22351030020
94	522 53 90-01	CONTROL SHAFT	1A646089670
95	535 40 28-33	SPRING PIN 3.0A * 16	22351030016
97	522 53 91-01	CONTROL LEVER	1A646029840
99	502 45 34-01	SEALANT	1A646099500
101	522 53 93-01	LOCK NUT 10	19216829860
102	522 53 94-01	WASHER 10 * 40 * 4	19216829810
103	522 53 95-01	SPRING	19216829790
104	525 32 61-01	SWASH PLATE KIT	1A646099630
105	522 53 96-01	STUD 10 * 60	26216100602
106	522 53 98-01	SEALING CAP 18	27260180000
107	522 54 00-01	WASHER 10 * 36 * 2.8	19216829840
108	522 54 01-01	COLLAR 10 * 22 * 17	19216829850
109	522 54 02-01	FRICTION PLATE KIT	19216829770
119	505 56 58-01	TAPPING SCREW	26476080162
200	502 45 33-01	K46 & T40 SEAL KIT (ALL MODELS)	1A646099140
201	522 54 03-01	REPAIR KIT(K46L,M,W,H,AW,AX)	1A646099570
555	525 32 62-01	CENTER CASE SERVICE KIT	1A646099680